

Refurbished Shop To Let

16 GREEN END 1,150 SQ FT

Whitchurch



GROUND FLOOR ONLY

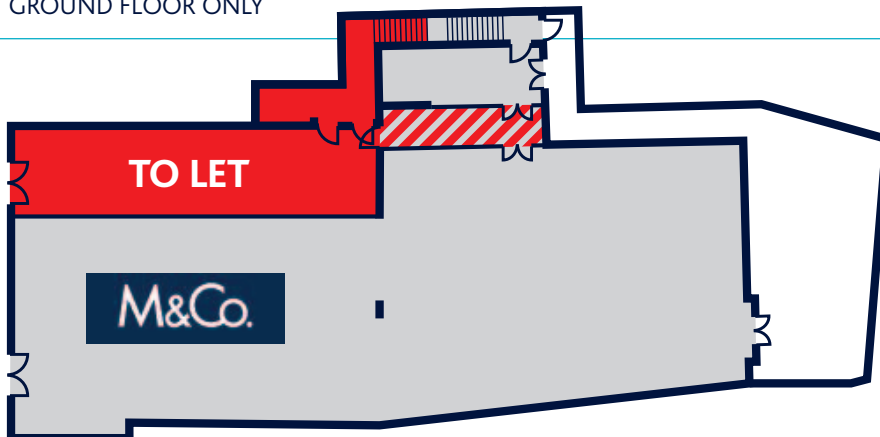

Frontage	19 ft	5.8m
Internal Width	17 ft 3"	5.3m
Shop Depth	62 ft 3"	19m
Ground Floor Retail	1,065 sq ft	99 sq m
Ground Floor Storage	80 sq ft	7.5m



Location

The property is situated in the heart of the town centre fronting Green End with multiple retailers nearby including Superdrug, Stead & Simpson, Hallmark Cards, Mackays and W H Smith.

The Developer

The developer has completely refurbished and extended the former World of Wicker to provide 2 shop units.

Rent

£22,500 pax.

Lease Terms

New 15 year effective full repair and insuring lease subject to 5 yearly upward only rent reviews.

VAT

All rents are exclusive of VAT unless specifically stated otherwise.

Hugh Ockleston



Further Information and Viewing

On request from the agents Ockleston Bailey:

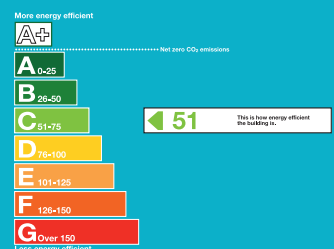

MISREPRESENTATION: These details were compiled in June 2012 and whilst every reasonable effort has been made by Ockleston Bailey to ensure accuracy, interested parties are strongly advised to take appropriate steps to verify by independent inspection or enquiry all information for themselves and to take appropriate professional advice. (i) No description or information given about the property or its value, whether written or verbal or whether or not in these particulars ('information') may be relied upon as a statement of representation or fact. Ockleston Bailey nor its Agents have any authority to make any representation and accordingly any information given is entirely without responsibility on the part of Ockleston Bailey or the seller / lessor. (ii) Any photographs show only certain parts of the property at the time they were taken. Any areas, measurements or distances given are approximate only. (iii) Any reference to alterations to, or use of any part of the property is not a statement that any necessary planning, building regulations or other consent has been obtained. These matters must be verified by any intending buyer / lessee. (iv) Any buyer, lessee must satisfy himself by inspection or otherwise as to the correctness of any information given.